

1 RAKE EDGE
NTS

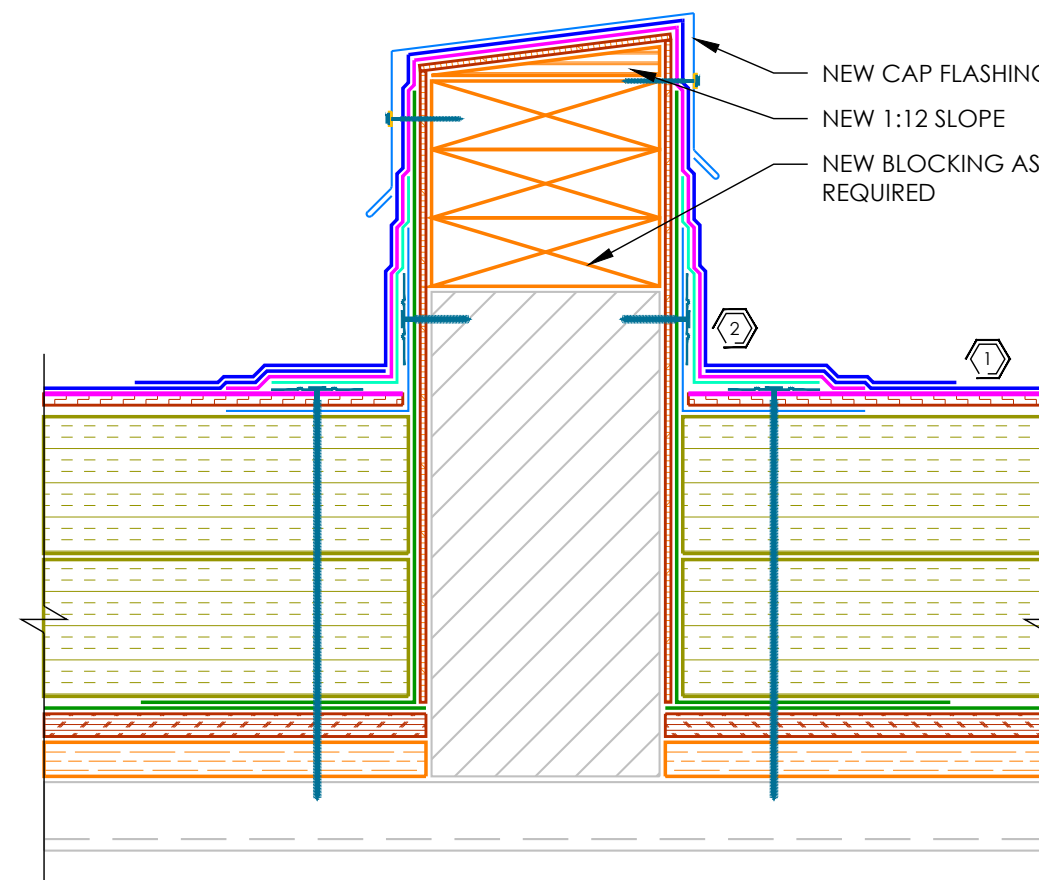

2 AREA DIVIDER
NTS

KEY NOTES

1. REFER TO DETAIL 1 ON A 5.01 FOR ROOF COMPOSITION.
2. REFER TO DETAILS 2 & 3 ON A 5.01 FOR PERIMETER RESTRAINT & BASE TIE-IN DETAILS.

RMIS ENGINEERING



389 MAXWELL CRESCENT
Regina, SK S4N 5X9
www.rmiseng.ca
Phone 306.352.4606
Fax 306.352.4607



WESTRIDGE
COMMUNITY CENTRE
C.13.MB.35-18.04.03

3 MARSHALL CRESCENT
WINNIPEG, MB R3T 4C3

CITY OF WINNIPEG

4TH FLOOR - 185 KING STREET
WINNIPEG, MB R3B 1J1

No.	DATE	DESCRIPTION

DESIGNED BY SMC 04/17/2018
DRAWN BY SED 04/17/2018
REVIEWED BY SMC 04/17/2018

RAKE & AREA
DIVIDER DETAILS

A 5.03